



## ADDITIONAL TIPS

- Elevate barrel on cinder blocks for increased pressure
- **WATER NOT FOR POTABLE USE**
- If you have a rain barrel without a diverter kit, call the Rain Barrel number for help, (414) 225-2128

## CONTACT US

**WEB** [www.freshcoast740.com/Learn/Rainwater-Harvesting](http://www.freshcoast740.com/Learn/Rainwater-Harvesting)  
[www.mmsd.com/RainBarrels.aspx](http://www.mmsd.com/RainBarrels.aspx)

**EMAIL** [freshcoast740@mmsd.com](mailto:freshcoast740@mmsd.com)

**PHONE** (414) 225-2128



# RAIN BARREL CARE

Manage Water Where it Falls



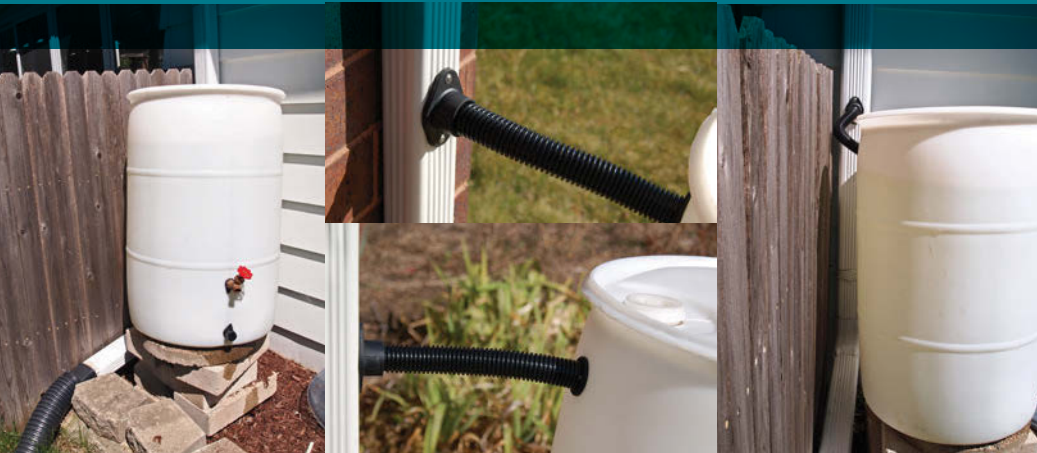

## INSTALLATION

Go to [mmsd.com](http://mmsd.com) and click the rain barrel tab for videos on how to assemble and install your rain barrel

For additional help with installing your rain barrel, follow the directions in the diverter kit or visit [www.earthmindedconsumerproducts.com](http://www.earthmindedconsumerproducts.com)



## PAINTING TIPS / HOW-TO

- 1 Wipe down the barrel with a one-to-one mixture of vinegar and water
- 2 Rough the surface of the barrel with a piece of fine grit sand paper
- 3 Apply a coat of latex bonding primer
- 4 Paint your design with "exterior latex paint"

- 1 Barrel
- 2 Spigot
- 3 Drain or hose attachment
- 4 Fill hose
- 5 FlexiFit™ Diverter
- 6 Winterizing Hole Cover

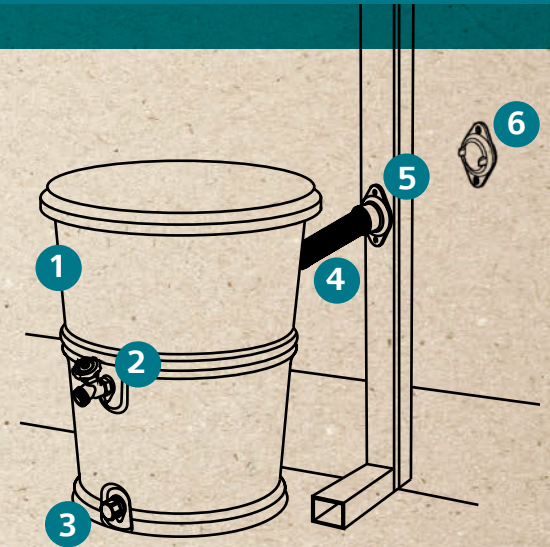

## MAINTENANCE

### SPRING

- Use the water in the rain barrel within 3 days if possible
- Check your gutters for debris
- Make sure your downspout is directed away from your house (minimum of 4', preferred 10')
- Check the seals around the spigot and drain/hose attachment
  - Additional pieces can be ordered through EarthMinded™
- Hook your rain barrel back up (directions in diverter kit)

### SUMMER

- Use the water in the rain barrel within 3 days if possible

### FALL

- Check your gutters for debris
- AT SEASON'S END:**
  - Remove leaves and empty the water out of the rain barrel
    - Remove leaves from the rain barrel by unscrewing the cap
    - Spray the inside of the barrel with water and shake leaves out
- Remove the diverter piece from the downspout
- Secure winter cap over the hole in the downspout
- Turn the rain barrel upside down and store in your garage or outside

### WINTER

- Let your rain barrel hibernate